

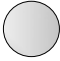





GR.01.3.06.XX

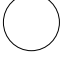
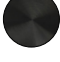
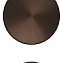

AVAILABLE FINISHES

-  **CR** | Chrome
-  **BI** | Brushed stainless steel
-  **BL** | Black
-  **WH** | White
-  **BB** | Brushed Black \*PVD
-  **BR** | Brushed Bronze \*PVD
-  **BC** | Brushed Copper \*PVD
-  **BG** | Brushed gun metal \*PVD
-  **BW** | Brushed white gold \*PVD

TECHNICAL DRAWING  
(MEASUREMENT IN MM)

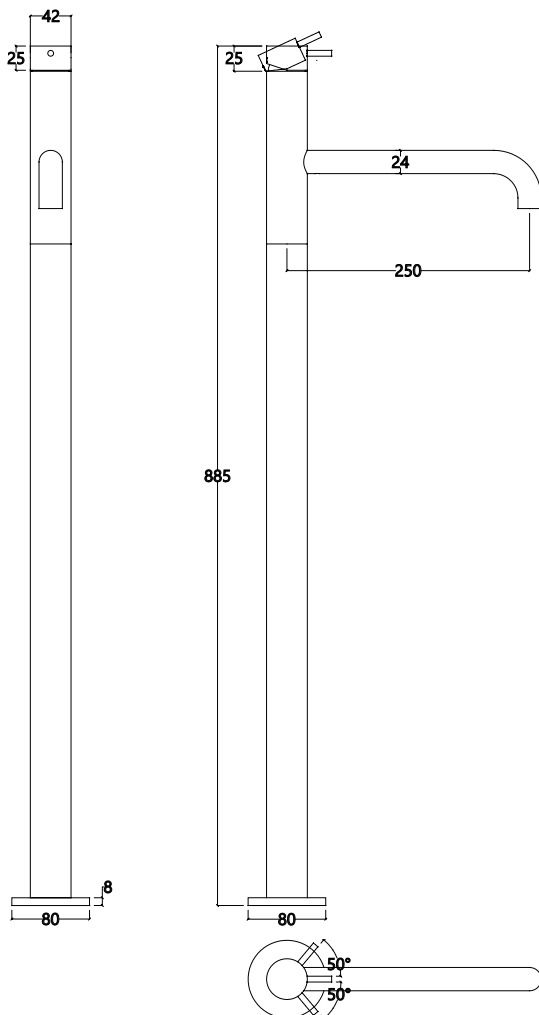

INSTALLATION RECOMENDATIONS

Before installing a tap, it is good to rinse the supply pipes to remove all residues. We also recommend installing the taps with a filter. The installation of the tap must be done with the surface clean and dry. To perform the water pressure test, the taps must be open.

CLEANING AND MAINTENANCE

Cleaning must be done with liquid soap and water. Do not use liquid detergents containing abrasive or acidic substances, abrasive sponges or disinfectants. Incorrect cleaning may permanently ruin the surface of taps. On color finishings, do not use products containing alcohol, acetone and other solvents.

WARRANTY

Formma guarantees all its products in case of manufacturing defects, as follows:

- 5-year warranty:
  - Fusion or porosity defects;
  - Cartridge defects (the wear of this component depends on water quality);
  - Chrome plating defects (defects caused by maintenance errors are excluded, please refer to cleaning instructions).
- 1-year warranty:
  - O-rings or fittings defects.
  - Defects on remaining finishes.

In order to use this warranty, please keep the invoice and attach it to this document.

Warranty grants the right of free replacement of parts that cause an irregular operation due to manufacturing defects, in every cases in which malfunction is not caused by incorrect use, maintenance errors, irregular installation, assembly made by unqualified people or reasons of force majeure. Defective products must be sent to formma, with shipping expenses borne by the sender – this warranty document and a copy of the purchase invoice must be attached to the package – where the products will be promptly replaced and send back with shipping expenses borne by formma.

Non-compliance of this conditions will render the warranty null and void. This warranty excludes any liabilities on the consequences arising from use or installation defects of formma products.

COMPONENT DRAWING

TECHNICAL DATA

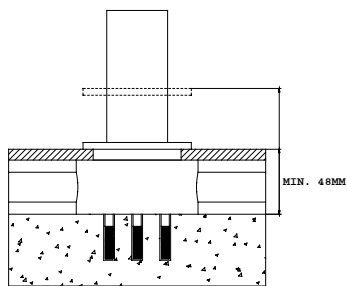

FLOOR STANDING BATHTUB MIXER MOUNTING

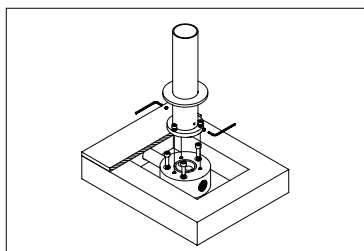

FOOT MOUNTING WITH PROTECTION COVER/ PRESSURE TEST

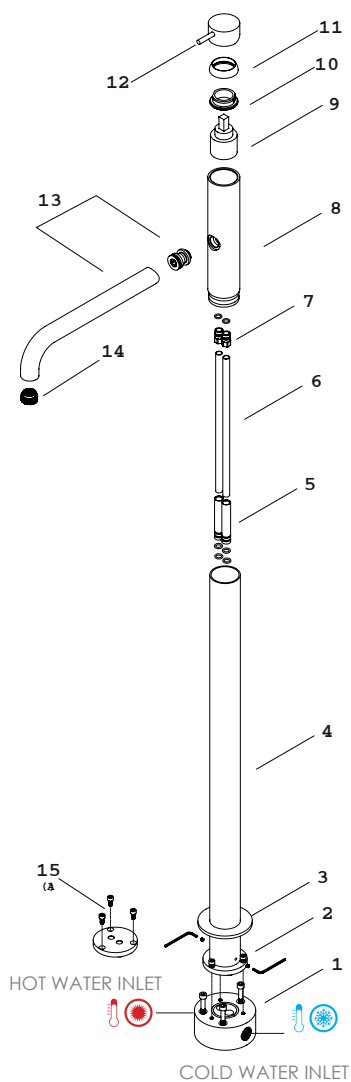
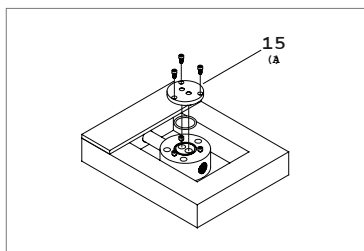

n°	DESCRIPTION
01	FLOOR BASE FIXING
02	FIXING PLATE
03	PLATE
04	INCREASE ELEMENT
05	TERMINALS
06	COPPER TUBES
07	CAP
08	TAP BODY
09	CARTRIGE
10	LOCKNUT
11	CARTRIDGES CONCEALER
12	HANDLES
13	SPOUT
14	AERATOR
15	PROTECTION COVER

**GR.01.3.06.XX**

GR.01.0.14 (Inner part)

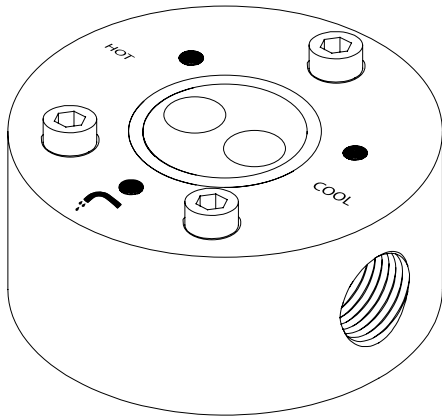

**TECHNICAL DATA**

MINIMUM PRESSURE	1 BAR
MAXIMUM PRESSURE	10 BAR
RECOMMENDED PRESSURE	2-5 BAR
MAXIMUM TEMPERATURE	70° / 176 F
RECOMMENDED TEMPERATURE	65° / 149 F
BUILT-IN DEPTH PROFUNDIDADE	5.6 l/min - 3 Bar

**TECHNICAL DRAWING  
(MEASUREMENTS IN MM)**

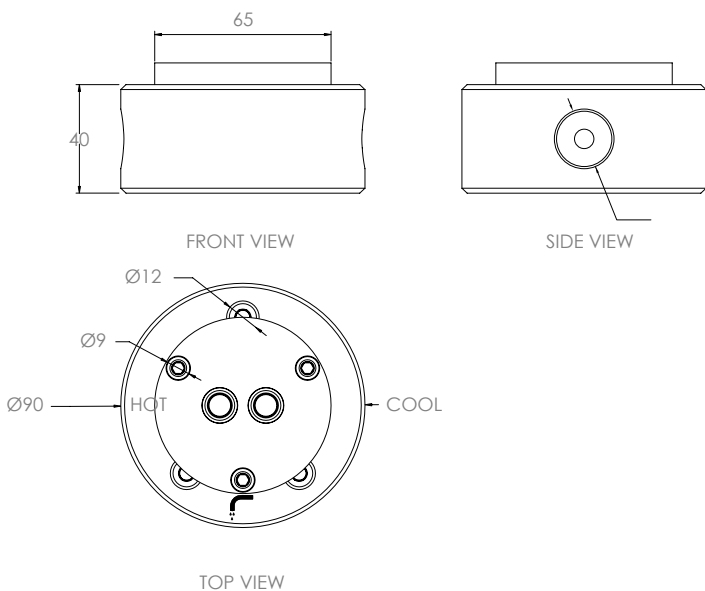

**INSTALLATION RECOMMENDATIONS**

The installation must be made by specialized technicians that have to consider the instructions contained on the product. The components of the product cannot be altered or modified, otherwise the warranty will be annulled. The recommended pressure and temperature must be strictly followed. If they are exceeded or reduced, it can cause permanent damages to the tap.

**CLEANING AND MAINTENANCE**

We recommend regular maintenance of the tap in order to assure the permanent good function of it. To clean the tap, please use a smooth cloth with water and neutral soap. Never use products with abrasives substances such as chloride acid, ammonia, acetone, vinegar, bleach or abrasive sponges. The usage of non-recommended products might damage permanently the surfaces which will annul the warranty.

**WARRANTY**

Formma guarantees all its products in case of manufacturing defects, as follows:

- 5 Year warranty:
    - Machining or casting faults and porosity defects;
    - Cartridge and valve defects (the wear of this component depends on water quality);
    - Chrome plating or PVD defects. Defects caused by improper use are excluded, please refer to the maintenance instructions.;
  - 2 Year warranty:
    - Powder Coating finishes. Defects caused by improper use are excluded, please refer to the maintenance instructions.
- Our responsibility is exclusively subject to defects originated on the production process.  
The warranty does not cover components subject to wear and tear, such as O-rings, gaskets, flexible hoses and joints for connections.

COMPONENT DRAWING

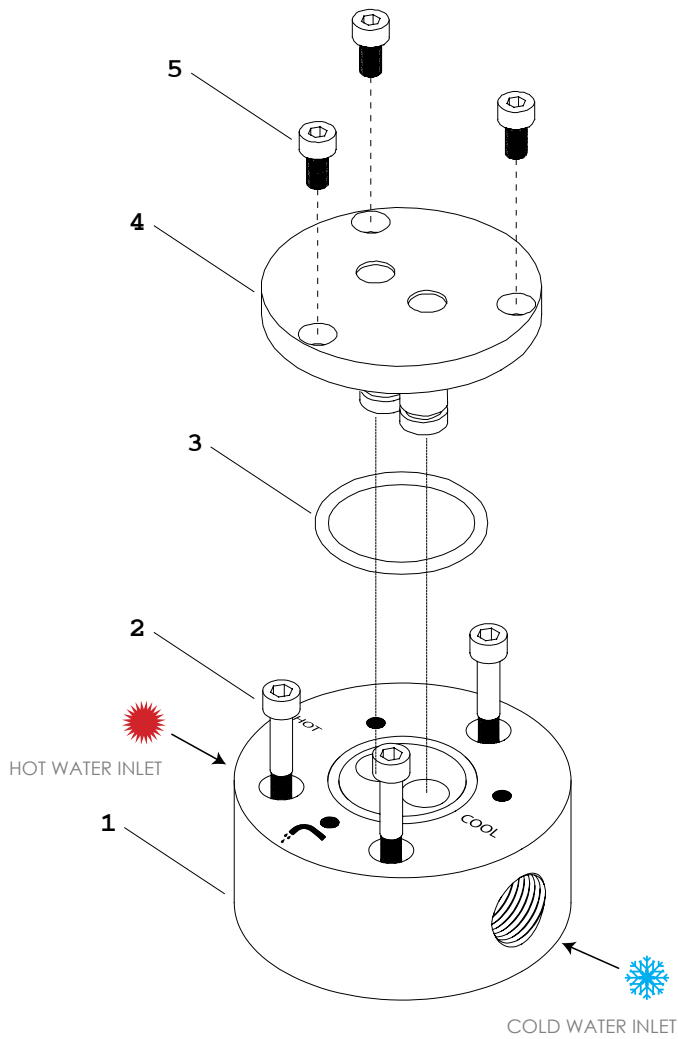

Attention :

Natural finishes, such as brass or stainless steel, depend entirely on the exposure to the environment and maintenance. Therefore, any stain that may appear cannot be considered a product defect. The warranty gives the customer the right to have all the parts replaced, free of charge, if they are not working properly, due to manufacturing fault.

The following are excluded from the warranty:

- Items or parts which are damaged or do not work properly due to negligence in the use or wrong maintenance;
- Wrong installation;
- Intervention by unqualified people or circumstances beyond one's control.

In order to use this warranty, please keep the invoice and attach it to this document. Defective products must be sent to Formma with shipping expenses borne by the sender. This warranty document and a copy of the purchase invoice must be attached to the package. The products will be promptly replaced and sent back with shipping expenses borne by Formma.

TECHNICAL DATA

n°	DESCRIPTION
01	FOOT MOUNTING
02	BASE SCREW
03	O'RING
04	PROTECTION COVER
05	SCREW COVER

ASSEMBLY INSTRUCTIONS

IMAGE 1

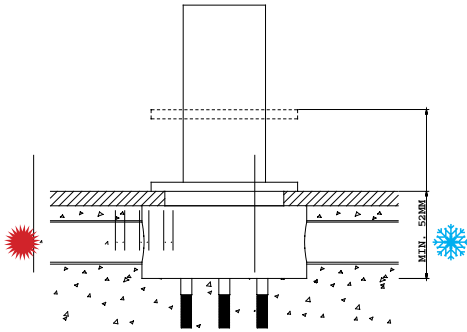

01- For assembly follow the indications of the drawing.

IMAGE 2

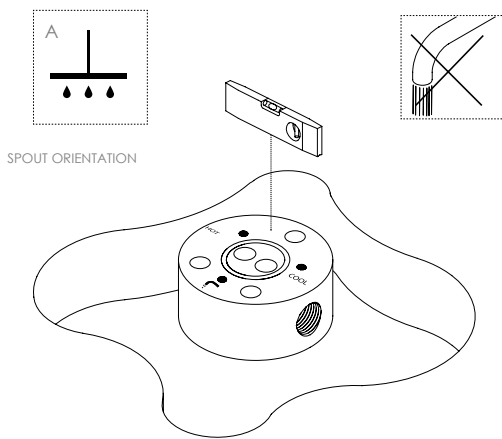

02 - Before starting assembly, it is essential to turn off the water supply. Please verify the minimum recommended measure, to build in the internal part. Please drill in the ground to build in the internal part. Please verify with the help of a level if the internal part is properly levelled and the icon (A) is oriented to the right Spout location.

IMAGE 3

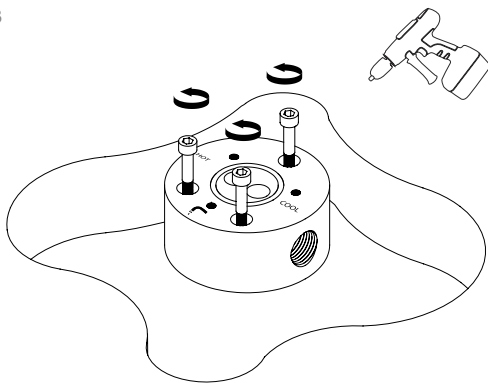

03 - Screw the internal part to the ground. Please use screws and plugs inside the packaging.

IMAGE 4

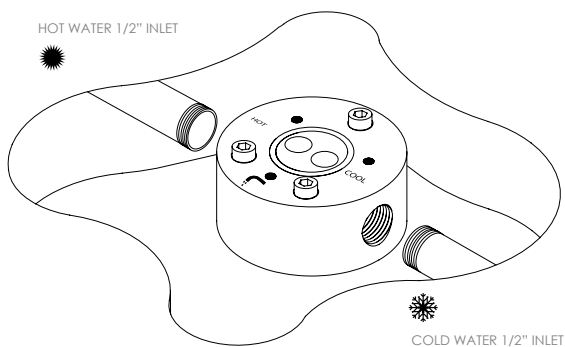

04 - Proceed with the water connection tightening the tubes corresponding to cold and hot water respectively.

## ASSEMBLY INSTRUCTIONS

IMAGE 5

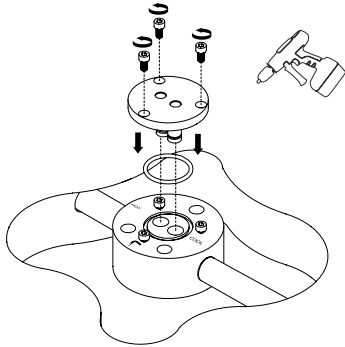

05 - Please apply the plastic cup to protect the build in part until the complete set up. This way the water exit is blocked. Screw the protection cap to the ground base.

IMAGE 6

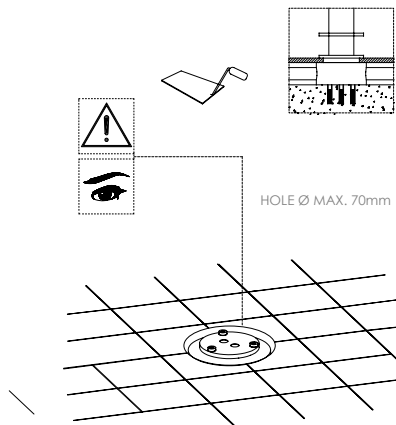

06 - Proceed to the pavement lay down. Leave an hole on the pavement cover with a maximum diameter of 70mm to set up the mixer plate.

IMAGE 7

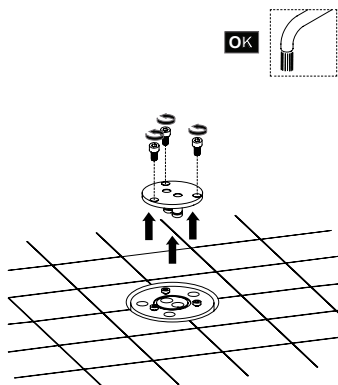

07 - Remove the white protection cap. Connect the water to remove any possible debris from the plumbing.