

TWO-WAY SHOWER MIXER WITH 200MM HEAD SHOWER AND HAND SHOWER

formma.

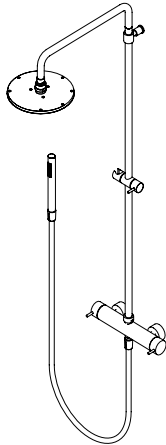



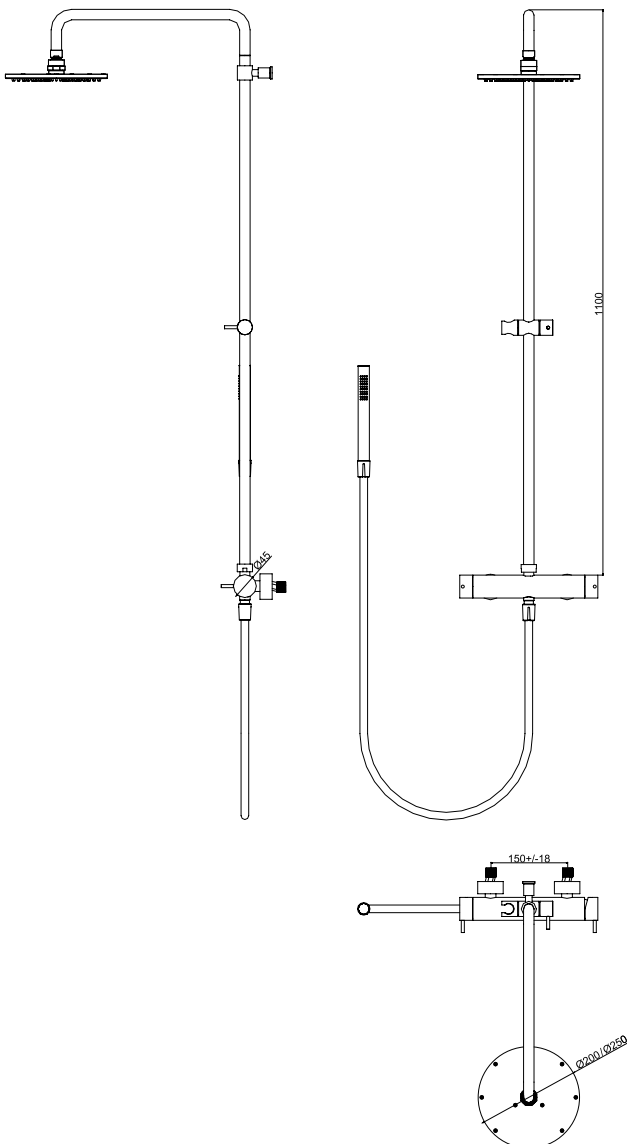

GR.01.3.11.XX

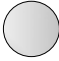

TECHNICAL DRAWING (MEASUREMENT IN MM)

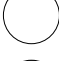

AVAILABLE FINISHES

-  **CR** | Chrome
-  **BI** | Brushed stainless steel
-  **BL** | Black
-  **WH** | White
-  **BB** | Brushed Black *PVD
-  **BR** | Brushed Bronze *PVD
-  **BC** | Brushed Copper *PVD
-  **BG** | Brushed gun metal *PVD
-  **BW** | Brushed white gold *PVD

INSTALLATION RECOMENDATIONS

Before installing a tap, it is good to rinse the supply pipes to remove all residues. We also recommend installing the taps with a filter. The installation of the tap must be done with the surface clean and dry. To perform the water pressure test, the taps must be open.

CLEANING AND MAINTENANCE

Cleaning must be done with liquid soap and water. Do not use liquid detergents containing abrasive or acidic substances, abrasive sponges or disinfectants. Incorrect cleaning may permanently ruin the surface of taps. On color finishings, do not use products containing alcohol, acetone and other solvents.

WARRANTY

Formma guarantees all its products in case of manufacturing defects, as follows:

- 5-year warranty:
 - Fusion or porosity defects;
 - Cartridge defects (the wear of this component depends on water quality);
 - Chrome plating defects (defects caused by maintenance errors are excluded, please refer to cleaning instructions).
- 1-year warranty:
 - O-rings or fittings defects.
 - Defects on remaining finishes.

In order to use this warranty, please keep the invoice and attach it to this document.

Warranty grants the right of free replacement of parts that cause an irregular operation due to manufacturing defects, in every cases in which malfunction is not caused by incorrect use, maintenance errors, irregular installation, assembly made by unqualified people or reasons of force majeure. Defective products must be sent to formma, with shipping expenses borne by the sender – this warranty document and a copy of the purchase invoice must be attached to the package – where the products will be promptly replaced and send back with shipping expenses borne by formma.

Non-compliance of this conditions will render the warranty null and void. This warranty excludes any liabilities on the consequences arising from use or installation defects of formma products.

COMPONENT DRAWING

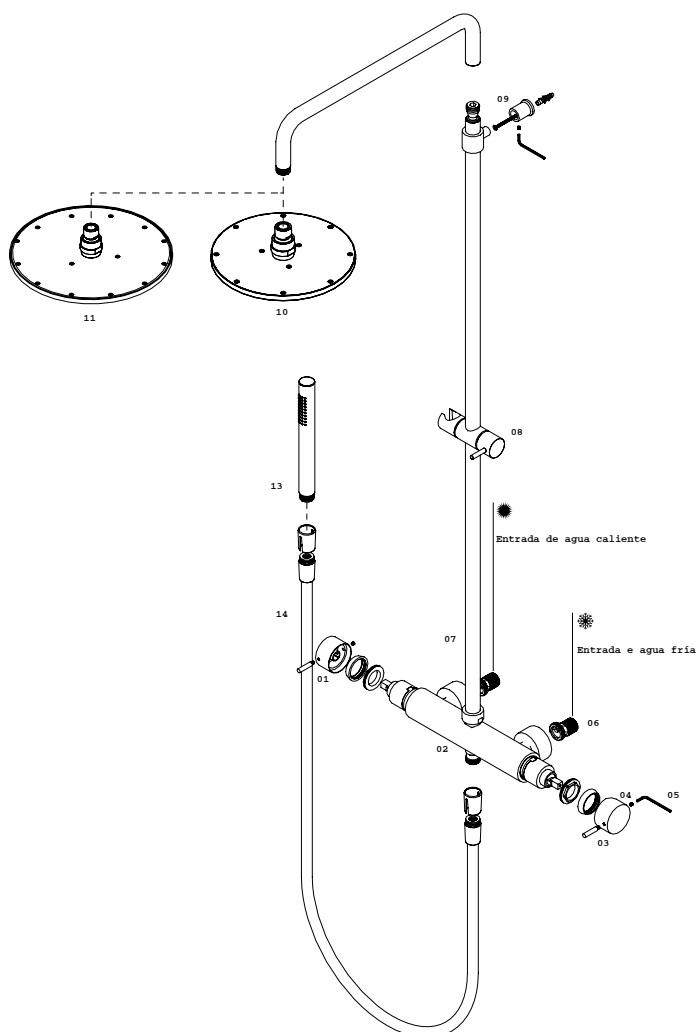

TECHNICAL DATA

MINIMUM PRESSURE	1 BAR
MAXIMUM PRESSURE	10 BAR
RECOMMENDED WORKING PRESSURE	2-5 BAR
MAXIMUM WATER TEMPERATURE	70° / 176 F
MAXIMUM WATER TEMPERATURE	65° / 149 F

COMPONENT LIST

n°	DESCRIPTION
01	TWO-WAYS DIVERTER HANDLE
02	SEAT
03	MIXER HANDLE
04	ALLEN SCREW
05	ALLEN KEY
06	1/2" ECCENTRIC
07	COLUMN
08	HAND SHOWER HOLDER
09	WALL MOUNTING
10	Ø200 SHOWER PLATE
11	Ø250 SHOWER PLATE
12	HAND SHOWER
14	HOSE

INTRUCCIONES DE MONTAJE

IMAGE 01

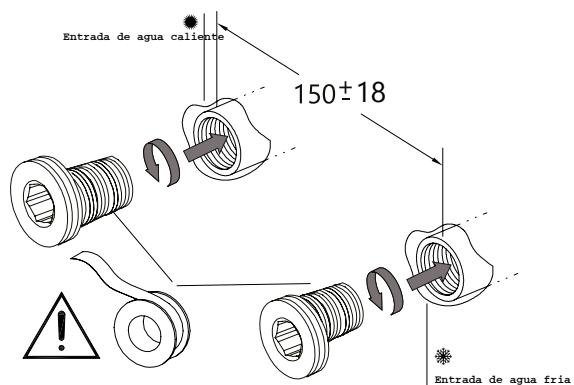

IMAGE 01

Apply teflon around the threads in order to seal the installation and prevent leakage. Afterwards tighten the eccentrics in the water tubes.

IMAGE 02

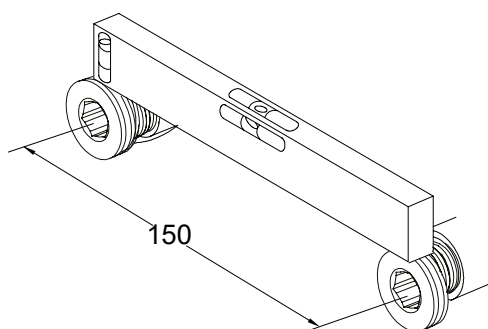

IMAGE 02

Check with the help of a spirit level if the eccentrics are correctly placed and the distance between the axes are correct (150mm). There is a tolerance of 18mm.

IMAGE 03

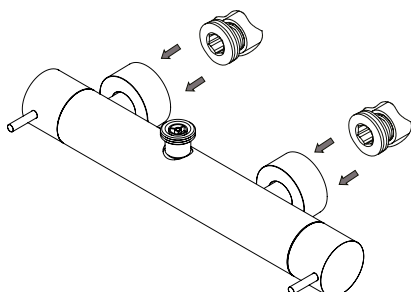

IMAGE 03

After the tightening of the eccentrics, adjust the mixer's backplates.

INTRUCCIONES DE MONTAJE

IMAGEN 04

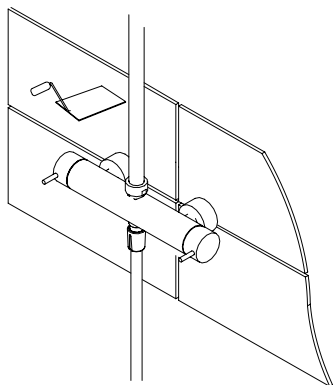

IMAGEN 04

Once the tiles have been placed, apply the backplates until the end of the eccentrics.